

AIR FORCE T.O. 35C2-3-442-14  
 ARMY TM5-6115-600-24P  
 NAVY NAVFAC P-8-628-24P  
 MARINE CORPS SL-4-07464B

SECTION II. REPAIR PARTS FOR ORGANIZATIONAL, INTERMEDIATE (FIELD),  
 (DIRECT AND GENERAL SUPPORT) AND DEPOT MAINTENANCE

(1) ILLUS- TRATION		(2) SMR CODE				(3) USMC		(4)	(5) DESCRIPTION	(6)	(7) QTY INC IN UNIT	(8) USMC QTY PER EQUIP	
a	b	a	b	c	d	a	b	NATIONAL STOCK NUMBER	REF NUMBER & MFR CODE	USABLE ON CODE	U/M		
FIG NO.	ITEM NO.	ARMY	AIR FORCE	NAVY	USMC	SSI	REPL FACTOR						
54		PAFHD	PAFDD	PAFHD	PAFHD			2815-01-040-3662	GROUP 10 - ENGINE		EA	1	1
									ENGINE SR3635 11083 (SEE FIGURES 16, 33, 37, 38, 39, 43, 44, 45, AND 52 THROUGH 78 FOR BREAKDOWN)				
54									AIR LINES				
54	1	PAOZZ	PAFZZ	PAHZZ	PAHZZ	D	.008	5305-00-115-9526	BOLT MS18154-58	96906	EA	1	9
54	2	PAOZZ	PAFZZ	PAHZZ	PAHZZ	D	.010	5310-00-117-4788	WASHER 5M2894	11083	EA	5	71
54	3	PAOZZ	PAFZZ	PAHZZ	PAHZZ	D	.013	5340-00-118-3095	CLIP 7MB322	11083	EA	1	1
54	4	AOO	AOO	MHH	MHH				TUBE ASSY 6N1022	11083	EA	1	1
54	5	PAOZZ	PAFZZ	PAHZZ	PAHZZ	D	.008	4730-00-013-7397	NUT 4B8756	11083	EA	2	2
54	6	PAOZZ	PAFZZ	PAHZZ	PAHZZ	D	.004	4730-01-068-7274	TUBE 5P11948	11083	EA	1	1
54	7	PAOZZ	PAFZZ	PAHZZ	PAHZZ	D	.006	4730-00-496-7511	ELBOW 9S7720	11083	EA	1	1
54	8	PAOZZ	PAFZZ	PAHZZ	PAHZZ	D	.008	4730-01-125-9776	PLUG 9L8492	11083	EA	1	1
54	9	PAOZZ	PAFZZ	PAHZZ	PAHZZ	D	.006	4730-01-125-9752	TEE 9L9045	11083	EA	1	1
54	10	PAOZZ	PAFZZ	PAHZZ	PAHZZ	D	.006	4731-00-277-9386	BUSHING 895-8D	80049	EA	1	1
54	11	PAFZZ	PAFZZ	PAHZZ	PAHZZ	D	.006	2990-01-032-7257	PIPE 6L3052	EA 11083	1	1	1
54	12	PAOZZ	PAFZZ	PAHZZ	PAHZZ		.030	5330-00-074-3773	PACKING, PREFORMED P/O KIT P/N 5P9117 4L8357	11083	EA	2	8
54	13	PAOZZ	PAFZZ	PAHZZ	PAHZZ	D	.008	5306-00-637-4956	BOLT S1588	11083	EA	4	21
54	14	PAOZZ	PAFZZ	PAHZZ	PAHZZ		.030	5330-00-760-7367	GASKET 5S6735	11083	EA	1	2
54	15	PAFZZ	PAFZZ	PAHZZ	PAHZZ			2815-01-032-2211	ELBOW 7L496	11083	EA	1	1

AIR FORCE T.O. 35C2-3-442-14  
ARMY TM5-6115-600-24P  
NAVY NAVFAC P-8-628-24P  
MARINE CORPS SL-4-07464B

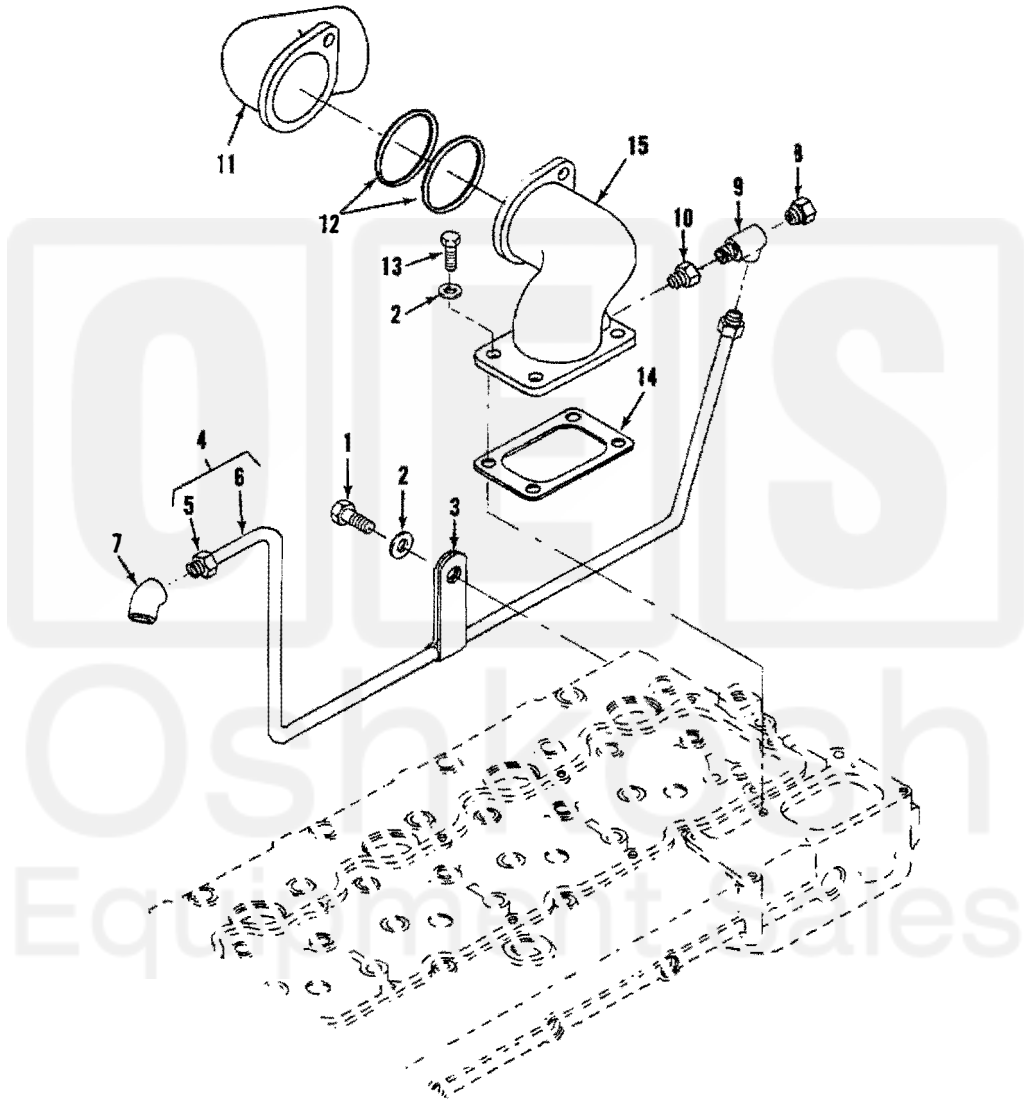

Figure 54. Air Lines